

TOUCH SCREEN DIGITAL KIOSK

PROLAB



Silver Border / Base



Golden Border / Base



Color Customization



HD Display



Android OS/
Windows OS

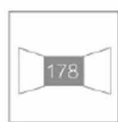

178° Full View



Centralized
Management
system

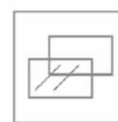

Tempered Glass



3D Noise
Reduction Display



1. High quality explosion-proof glass, high light transmittance, anti-violent, scratch-resistant, dust-proof and waterproof.
2. Professional chip and processing technology to ensure high image quality.
3. Industrial high-performance LCD screen ensures high image clarity, high brightness and stability of use.
4. The shell is made of high-strength steel, which is ultra-thin, beautiful and strong, and has excellent protection performance.
5. The surface is fine-grained, smooth and even, with good anti-rust and wear-resisting functions.
6. A variety of signal interfaces, supporting a variety of signal input / output.
7. Adopt industrial industrial control board, Android system.

Body Structures

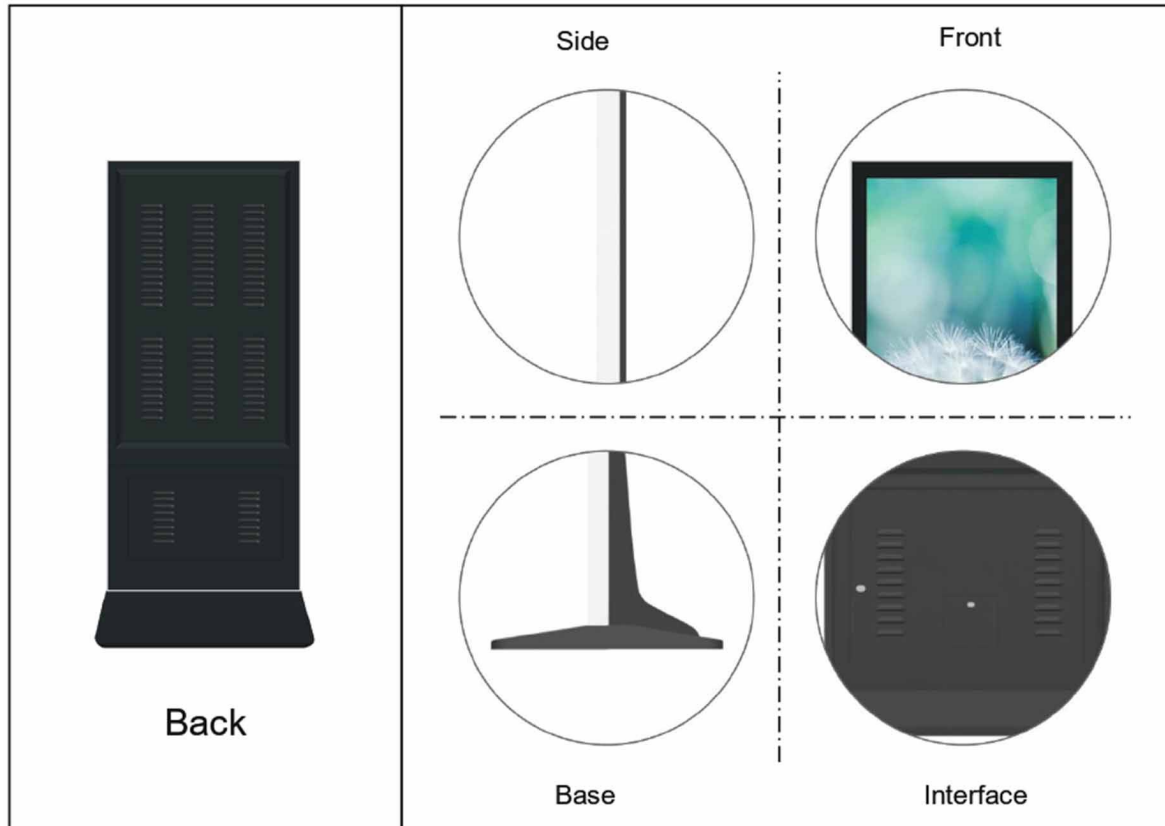

Body Structures



Technical Parameter

Product Model					
Screen Parameters	Size	43" - 86"	Audio system	Horn	2× 5W (8Ω)
	Back type	Backlight integration		Sound mode	standard
	Display Proportion	16 : 9	Output Interface	PC output interface	R J 45 *1, USB*2
	Physical resolution	1920X 1080		L /R Audio output	1 RCA * 2
	Color depth	16.7M	Power consumption	input voltage	100~240v 50/60HZ
	Viewing angle	R /L /U /D 89/89/89/89		Standby power / rated power	≤ 3W /≤ 180W
	Brightness	450 cd/m ²	Cabinet	Material	S P C C
	Contrast	5000:1		Exterior color	Black(default),gold, silver
	Response time	5ms	External conditions	Working temperature / humidity	0 ~50 /20% ~80%
	Service time	60000 hours		Storage temperature / humidity	- 10 ~60 /5- - 95%

Power consumption table

Series	Screen size	Power				
		43"	49"	55"	65"	86"
Standalone version		85W	100W	115W	180W	380W
Android system		85W	100W	115W	180W	380W
Low Power Consumption One Machine Series		100W	120W	135W	180W	300W
Desktop Machine Series		170W	190W	220W	250W	390W

Touch Panel Solutions

Touch Panel Options	Infrared Touch (IR Touch)	Capacitive Touch	Nano Capacitive Touch
Touch Points	10 points touch	10 points touch	10 points touch
Material	IR Tube	G +G	G +F
Response Time	<8ms	<3ms	<5ms
Touch Times	50 million times	50 million times	50 million times
Transmittance	0.92	0.95	0.85

Standalone OS Solutions

Version	C P U	Internal Storage	Out Storage	Interface	System supporting
Display Version	E 9- B 11/ E 9- B NC /E 6J- AV	No storage	USB/HDD/SSD	HDMI/VGA/DV I/USB	Android /Windows/Linux OS
Standalone Version	Mstar V 56	No storage (8G /16G available)	support SD card & USB Flash	HDMI/USB /SD	Only Standalone OS

Android OS Solution

Configuration	CPU	Chip Architecture	Processor	Maximum Resolution Support	System Version	Storage
Basic level	A20	Cortex-A7	Dual-Core	1080P	Android 4.1	512Mb +8G
	A33	CortexTM-A7	Quad-Core	1080P	Android 4.4	512Mb/1G b +8G
	A64	Cortex-A53	Quad-Core	1080P	Android 5.1	512Mb/1G b +8G
Middle level	RK3128	Cortex-A7	Quad-Core	1080P	Android 6.0	512Mb/1G b +8G
	RK3368	Coretex-A53	Octa-Core	2K /4K	Android 6.0	1Gb/2Gb +8G
	RK3188	Cortex-A9	Quad-Core	2K	Android 6.0	1Gb/2Gb +8G
Top level	RK3288	Cortex-A17	Quad-Core	4K	Android 6.0	2Gb +8G
	RK3399	Cortex-A72	Dual-Core	4K	Android 7.1	4Gb +16G
	RK3399	Cortex-A72	+Quad-Core	4K	Android 7.1	4Gb +16G
	Amlogic T960X	Cortex- A53	Quad-Core	4K	Android 7.1	2Gb+8G

Windows OS Solution

Operating System	CPU	System Version	Graphics	RAM	Storage
Windows OS	Core- i3	Win 7 / Win 10	3.7 HZ / 3.9 HZ	4G (8G available)	120G SSD / 500G HDD
	Core- i5	Win 7 / Win 10	3.2 HZ / 3.4 HZ	4G (8G available)	120G SSD / 500G HDD
	Core- i7	Win 7 / Win 10	3.4 HZ / 3.6 HZ	4G (8G available)	120G SSD / 500G HDD